

										BANDALUX																																		
REVISION										<div><div>X</div><div>2</div><div>3</div><div>4</div><div>5</div><div>6</div><div>7</div><div>8</div><div>9</div></div>																																		
FECHA										08-04-2013																																		
DIBUJADO										Ivan Acosta																																		
ESCALA										Tolerancias general																																		
1:1										<table><tr><td>></td><td colspan="2">5</td><td>11</td><td>20</td><td>35</td><td>55</td><td>80</td></tr><tr><td>Hasta</td><td>5</td><td>11</td><td>20</td><td>35</td><td>55</td><td>80</td><td>120</td></tr><tr><td>±</td><td colspan="2">0.1</td><td>0.150</td><td>0.18</td><td>0.2</td><td>0.25</td><td>0.3</td><td>0.35</td></tr></table>										>	5		11	20	35	55	80	Hasta	5	11	20	35	55	80	120	±	0.1		0.150	0.18	0.2	0.25	0.3	0.35
										>	5		11	20	35	55	80																											
										Hasta	5	11	20	35	55	80	120																											
										±	0.1		0.150	0.18	0.2	0.25	0.3	0.35																										
FORMATO										A-3																																		
Cortina enrollable Z-Box 100										Guía 50mm Instalación frontal/lateral																																		
Mecanismo a motor										Terminal Zip																																		

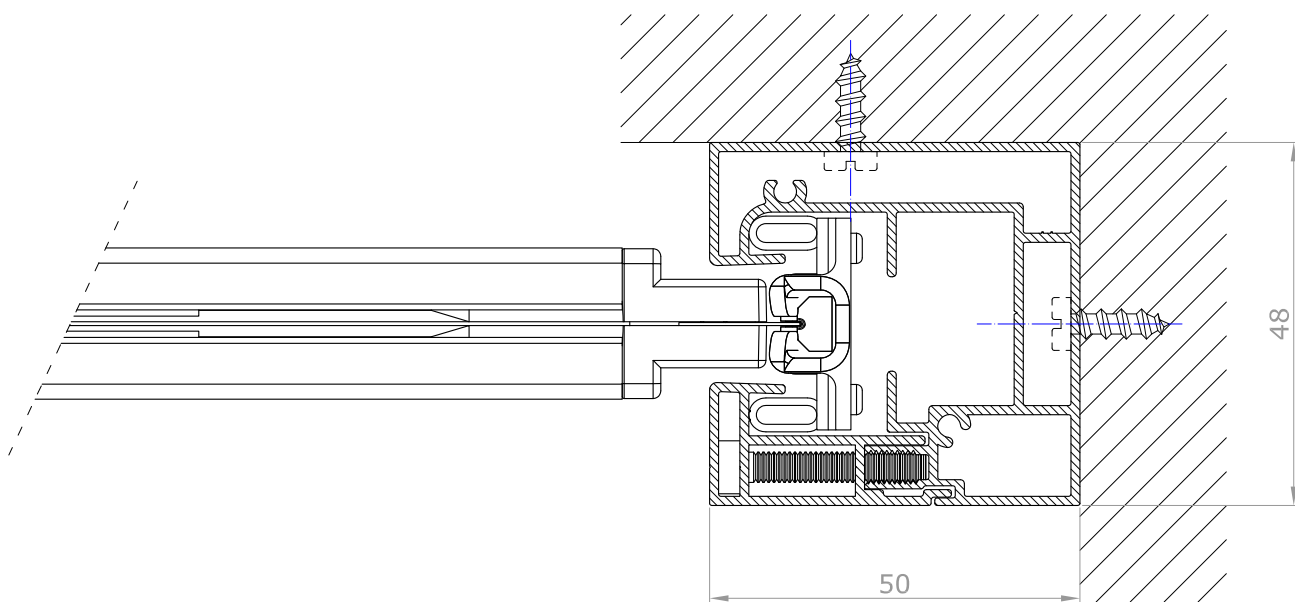
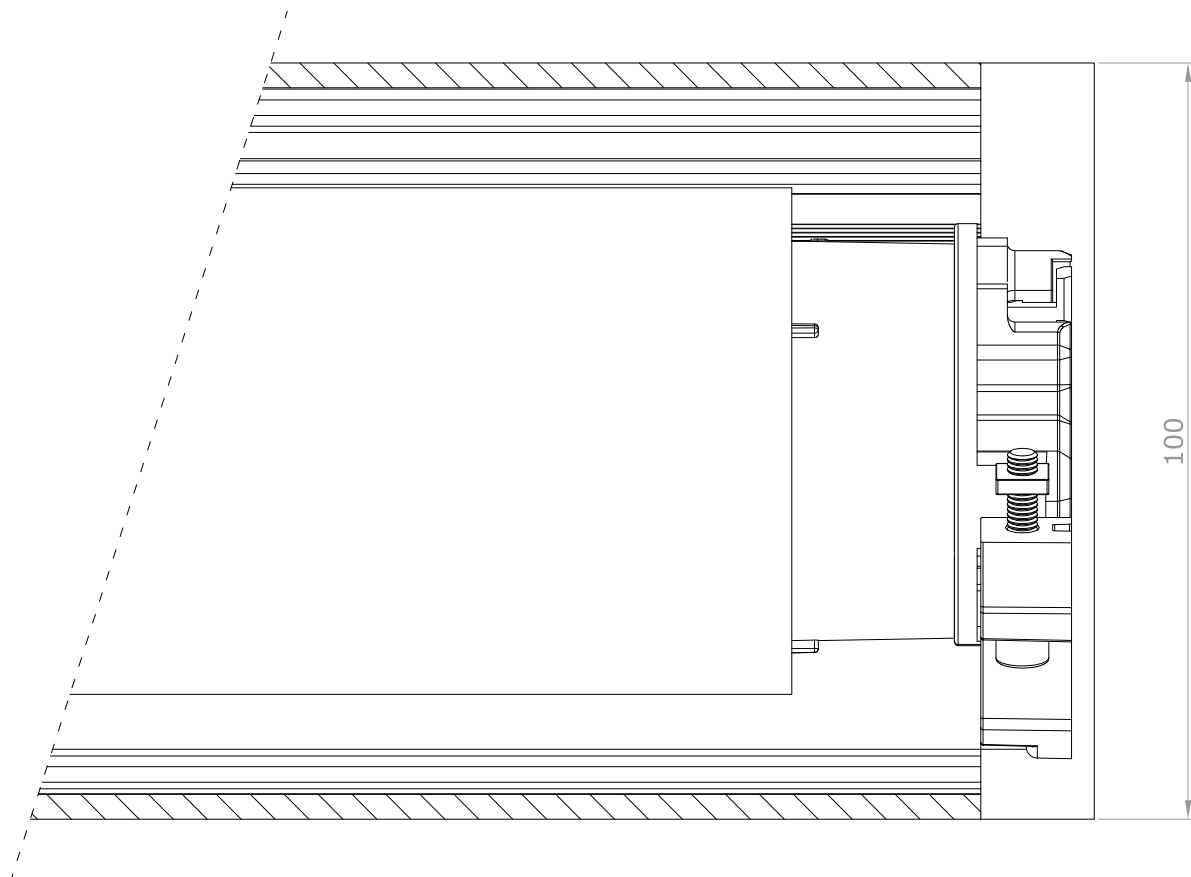

REVISION	<div> <div></div> <div>2</div> <div>3</div> <div>4</div> <div>5</div> <div>6</div> <div>7</div> <div>8</div> <div>9</div> </div>							BANDALUX	
FECHA	08-04-2013							PLANO N°	
DIBUJADO	Ivan Acosta							FORMATO	A-4
ESCALA	Tolerancias general							Cortina enrollable Z-Box 100	
1:1	>		5	11	20	35	55	80	Guía 50mm instalación frontal/lateral
	Hasta	5	11	20	35	55	80	120	Mecanismo a motor
	±	0.1	0.15	0.18	0.2	0.25	0.3	0.35	Terminal Zip